

PROLIAD

LED LIGHTING

Light quality:



Color temperature:

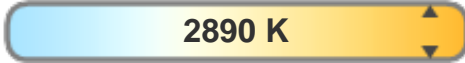

Output: 697 lm
Peak: 1982 cd
Power: 12,5 W
PF: 0,88

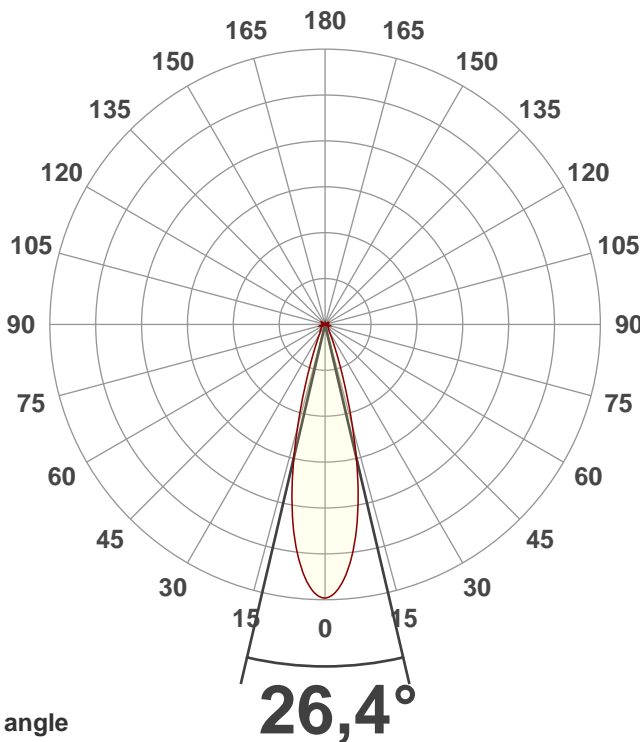

Beam angle

26,4°

Color



CIE1931
x: 0,447
y: 0,410

Spectra

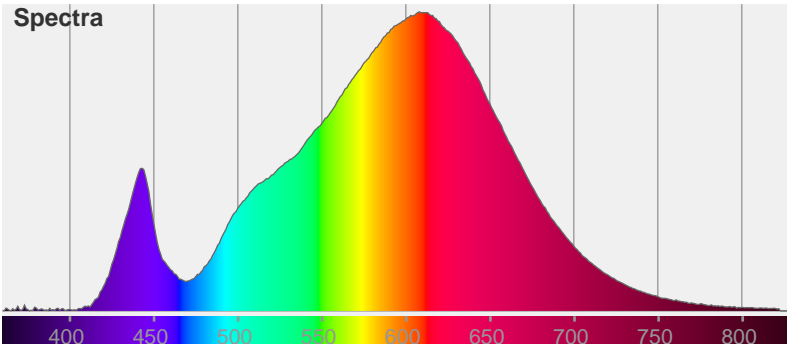

Power

Voltage: 230 V
Current: 0,062 A

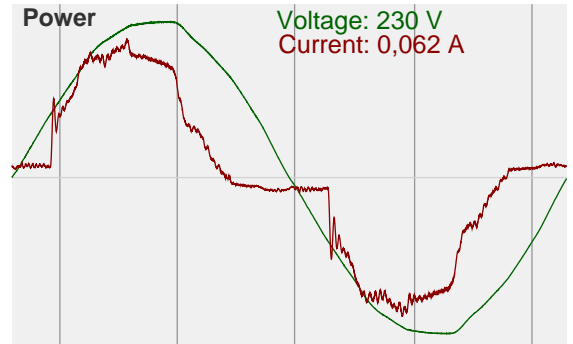

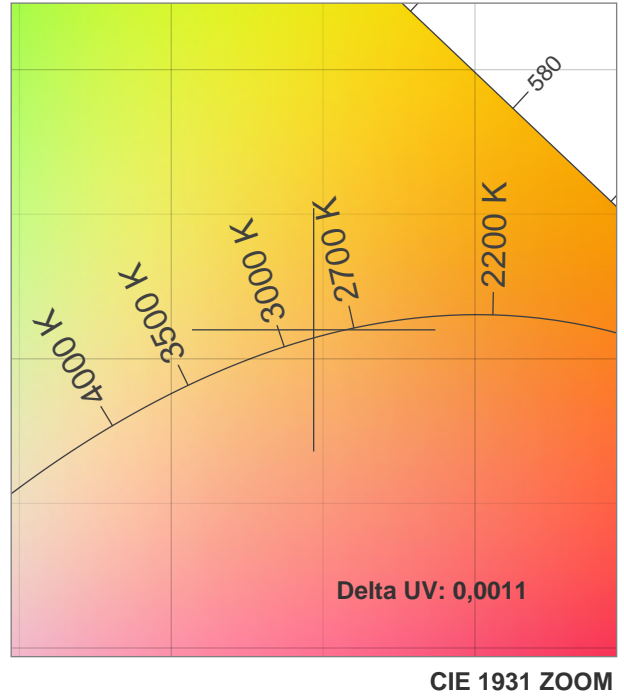
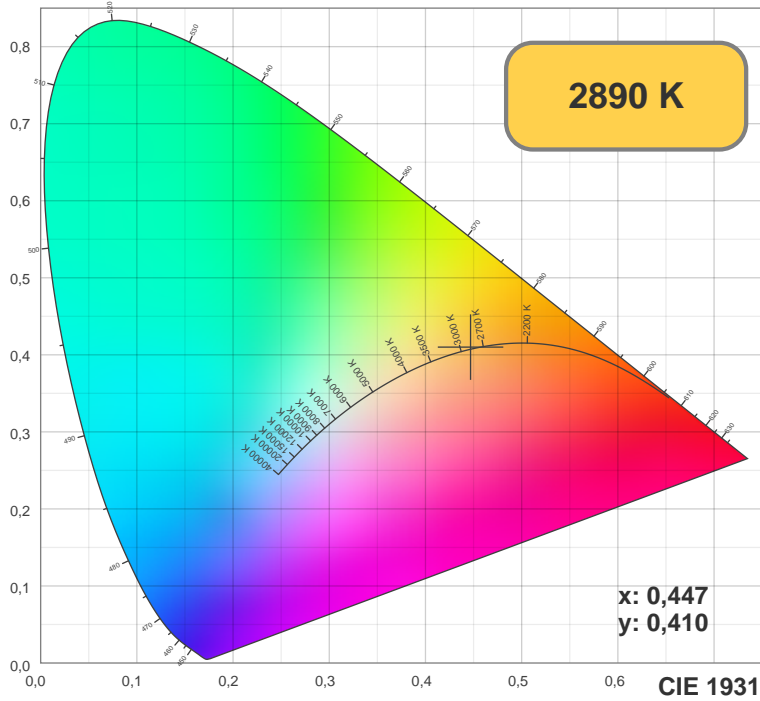

TM30: 81,9

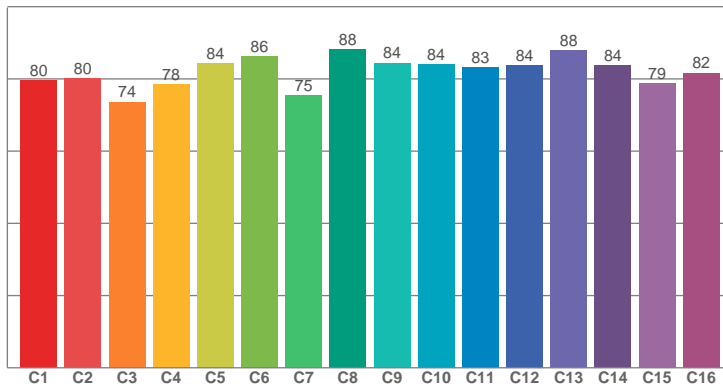

CRI: 83,7 (R1-R8)

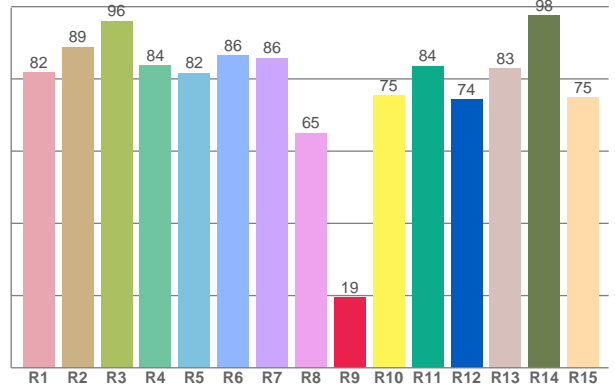

CRI R values, only R1-R8 are used to calculate final CRI value

R1	R2	R3	R4	R5	R6	R7	R8	R9	R10	R11	R12	R13	R14	R15
81,70	88,89	96,09	83,71	81,68	86,48	85,82	65,07	19,43	75,35	83,56	74,28	82,81	97,53	74,95

TM30 C values, 16 binned values out of total of 99 C values

C1	C2	C3	C4	C5	C6	C7	C8	C9	C10	C11	C12	C13	C14	C15	C16
79,65	80,04	73,66	78,38	84,37	86,15	75,49	88,19	84,39	84,06	83,20	83,80	87,86	83,67	78,80	81,63

CQS Q values

Q1	Q2	Q3	Q4	Q5	Q6	Q7	Q8	Q9	Q10	Q11	Q12	Q13	Q14	Q15
75,16	96,41	85,65	83,29	82,47	80,40	83,02	87,29	96,11	88,35	86,54	84,71	84,03	73,62	74,08

CQS: 82,6

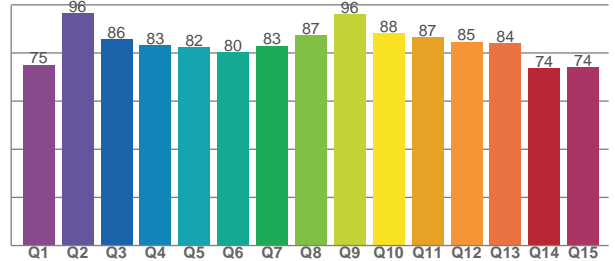

Color parameters

CCT	CRI	CRI R9	TM30 Rf	TM30 Rg	CQS	x	y	u	v	Duv
2890 K	83,7	19,4	81,9	99,3	82,6	0,4	0,4	0,3	0,4	0,0011

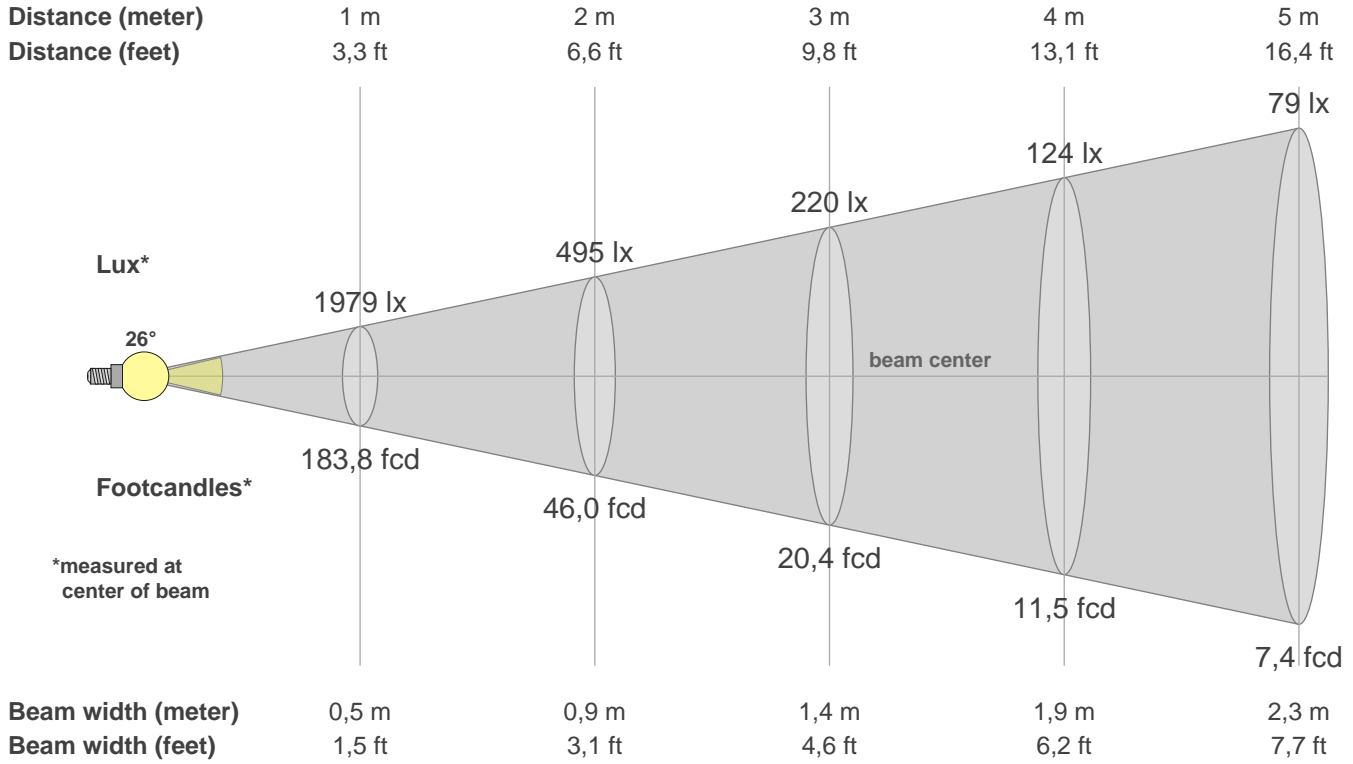

Intensities in 0° c-plane

0°	2°	4°	6°	8°	10°	12°	14°	16°	18°	20°	22°	24°	26°	28°	30°	32°	34°	36°	38°
1979	1949	1860	1731	1563	1363	1135	893	658	458	311	216	152	111	84	67	57	49	45	41
100%	98%	94%	87%	79%	69%	57%	45%	33%	23%	16%	11%	8%	6%	4%	3%	3%	2%	2%	2%

Intensities in 0° c-plane

0°	2°	4°	6°	8°	10°	12°	14°	16°	18°	20°	22°	24°	26°	28°	30°	32°	34°	36°	38°
1979	1949	1860	1731	1563	1363	1135	893	658	458	311	216	152	111	84	67	57	49	45	41
100%	98%	94%	87%	79%	69%	57%	45%	33%	23%	16%	11%	8%	6%	4%	3%	3%	2%	2%	2%

Intensities in 180° c-plane

0°	2°	4°	6°	8°	10°	12°	14°	16°	18°	20°	22°	24°	26°	28°	30°	32°	34°	36°	38°
1979	1948	1865	1735	1569	1368	1137	894	659	464	325	232	170	128	101	83	71	63	58	54
100%	98%	94%	88%	79%	69%	57%	45%	33%	23%	16%	12%	9%	6%	5%	4%	4%	3%	3%	3%

Intensities in 180° c-plane

0°	2°	4°	6°	8°	10°	12°	14°	16°	18°	20°	22°	24°	26°	28°	30°	32°	34°	36°	38°
1979	1948	1865	1735	1569	1368	1137	894	659	464	325	232	170	128	101	83	71	63	58	54
100%	98%	94%	88%	79%	69%	57%	45%	33%	23%	16%	12%	9%	6%	5%	4%	4%	3%	3%	3%

Beam angle 50%	Field angle 10%	Cutoff angle 2,5%	Intensity ratio in 120° cone	Intensity ratio in 90° cone
26,4°	45,3°	74,8°	74,8%	69,7%

Flicker curve (Complete sampled flicker signal)



Flicker frame (frame of one period)

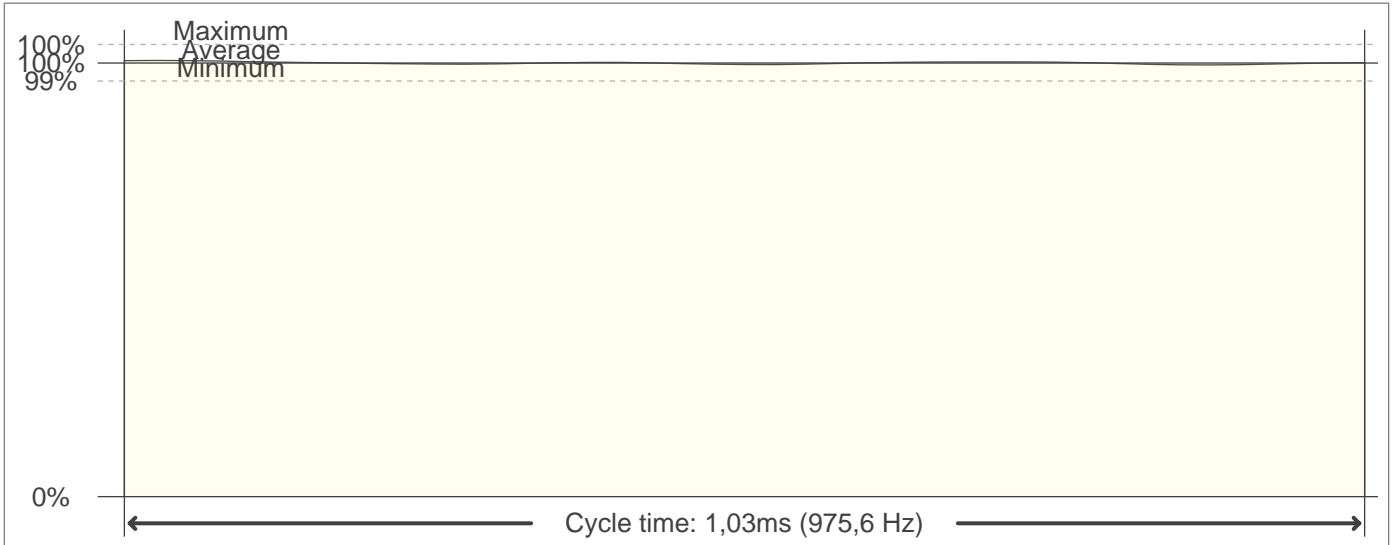

Flicker FFT (frequency scope of flicker curve)

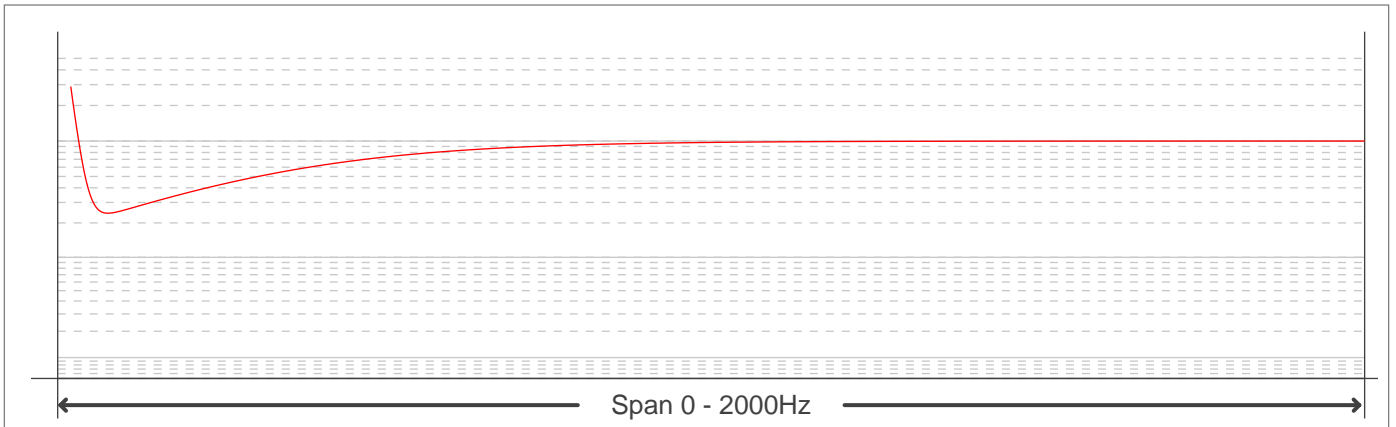

Flicker results:

Flicker frequency:	975,61 Hz
Flicker index:	0
Flicker percentage:	1,2 %
SVM: (Visual flicker)	0

Flicker conditions:

Sample Rate	40000 samples/second
-------------	----------------------